

MARINA PLAZA

**Everything you want,
nothing you don't.**

2320 MARINSHIP WAY

LEASED BY  TRANSWESTERN

OWNED BY  Berg Holdings



Get away while getting it done.

Tucked away on the cerulean shores of Richardson Bay in Sausalito, Marina Plaza on Richardson Bay is your destination for tranquility, decompression, and productivity. Your new workplace immerses you in glittering waterfront views, verdant outdoor space, and picturesque onsite Marina—all before you even walk in the front door and take in the dynamic, Class A workspace with all the comforts of home.

Arrive by ferry, transit, car—our ample lot includes electric vehicle charging stations—or by walking or biking Sausalito's scenic walking path straight to the front door. Each of our workspaces feature en suite terraces to drink in the view and salt-infused air. Central to myriad dining and lifestyle amenities, such as the nearby tennis courts and health club, Marina Plaza is truly a haven.



Where you want to be.

Marina Plaza provides Class A space with a fusion of private offices and collaboration spaces.

- ≈ The building is suffused with natural light and clean air, whether working inside or outside.
- ≈ **Vacancies are available starting at 1,392 SF, along with an opportunity to secure a single-tenant occupancy of 43k+ SF.**
- ≈ Each 15,000 SF floor plate is individually available.
- ≈ Marina Plaza features onsite showers, kitchens, quiet rooms, and a reliable Fiber IT infrastructure.
- ≈ Tenants are given wait list preference at our Marina, which can accommodate vessels up to 110'.
- ≈ Flexible T.I. allowances empower you to forge your perfect workspace—even more than it already is.



[See Current Availability](#)



Floor 1

15,040 SF available

Two private ground-level entrances

Private deck space

[View Virtual Tour](#)

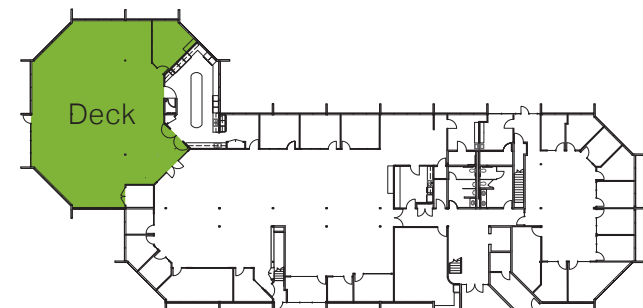



Floor 2

15,646 SF available

Expansive kitchen & dining space

Private deck space

[View Virtual Tour](#)

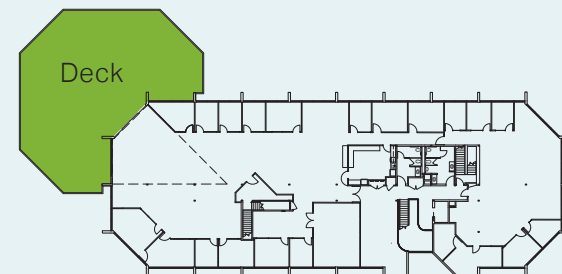



Floor 3

12,489 SF available

Best office views of Richardson Bay

Private deck space

[View Virtual Tour](#)



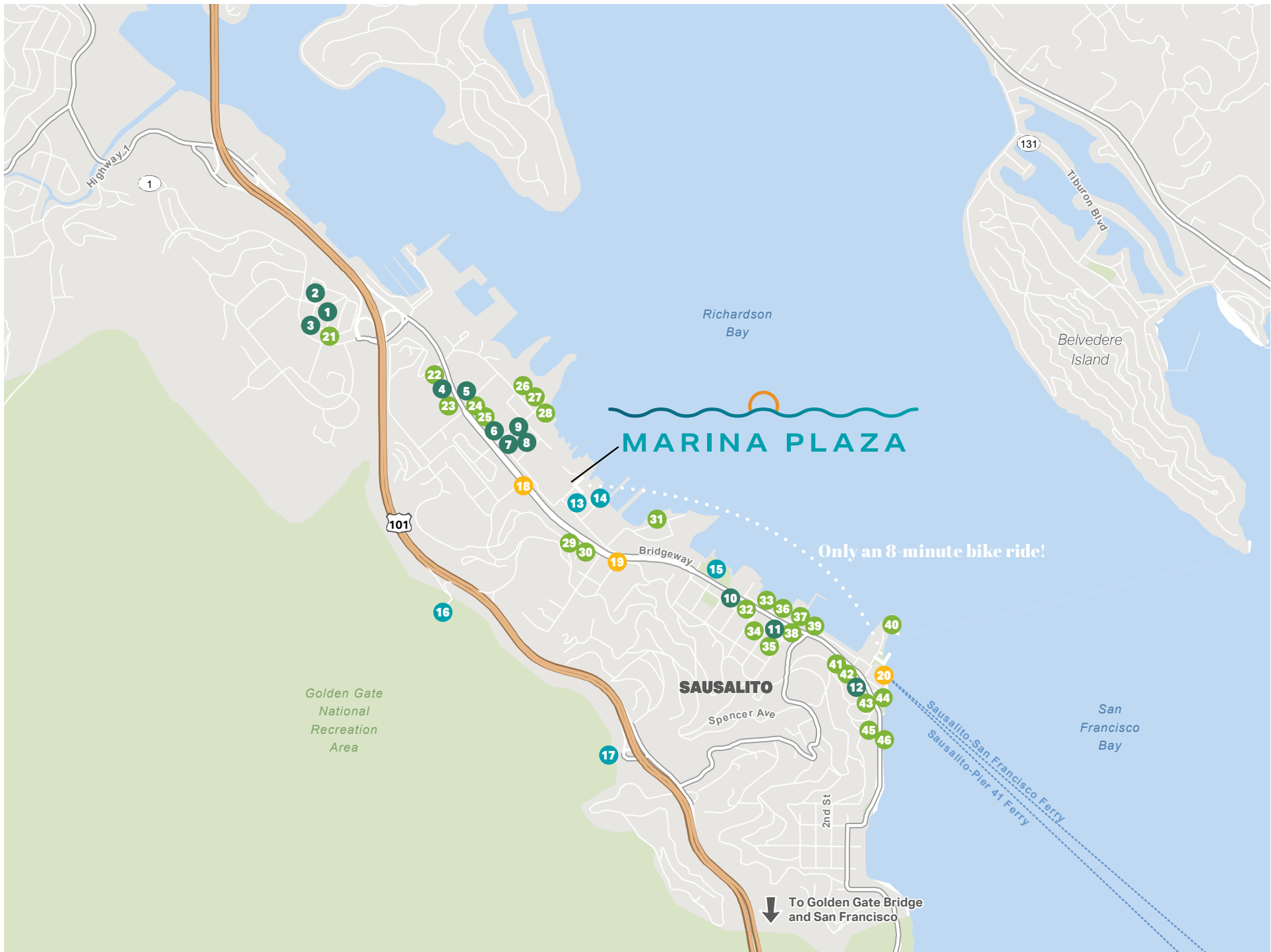

Convenience and charm.

Take refuge in Sausalito's vibrant and eclectic local culture and enjoy all of the waterfront splendor. With nearby amenities, easy commute, and the beautiful seaside, Sausalito is an unbeatable location.

Average Commute Times:

FROM: Marina Plaza

San Rafael	16 mins
San Francisco	15 mins
Petaluma	35 mins
Berkeley	44 mins
Walnut Creek	57 mins
San Mateo	59 mins

Retail

- 01 Marin Gateway Shopping Center
- 02 Target
- 03 CVS
- 04 UPS Store
- 05 Cartelligent
- 06 Westamerica Bank
- 07 FedEx
- 08 Mollie Stone's Market
- 09 USPS
- 10 Waterstreet Hardware
- 11 Sausalito Market
- 12 Wells Fargo Bank

Outdoors & Fitness

- 13 MLK Tennis Courts
- 14 Sea Trek Kayak & Stand Up Paddle Board Center
- 15 Dunphy Park
- 16 Rodeo Trailhead
- 17 Morning Sun Trailhead

Commuting

- 18 Bridgeway & Nevada St. Bus Stop
- 19 Bridgeway & Easterby St Bus Stop
- 20 Sausalito Ferry Terminal

Dining

- 21 Starbucks
- 22 Tommy's Wok
- 23 Bridgeview Bagel
- 24 Avatar's
- 25 Feng Nian
- 26 Anchorage 5
- 27 Sausalito Seahorse
- 28 Fish
- 29 Saylor's Restaurant
- 30 Fred's Place
- 31 Le Garage
- 32 Lighthouse Café
- 33 Salito's Crab House
- 34 Sushi Ran
- 35 Osteria Divino
- 36 Bar Bocce
- 37 Seafood Peddler
- 38 Firehouse Coffee & Tea
- 39 Taste of Rome
- 40 The Spinnaker
- 41 Poggia Trattoria
- 42 Copita
- 43 Lappert's Ice Cream
- 44 Barrel House Tavern
- 45 Sausalito Bakery & Café
- 46 The Trident



Mike McCarthy
SENIOR MANAGING DIRECTOR

mike.mccarthy@transwestern.com
404.842.6509
License Number: #00929942

Brian McCarthy
VICE PRESIDENT

brian.mccarthy@transwestern.com
404.842.6509
License Number: #01840990

Maddie Meyersieck
ASSISTANT VICE PRESIDENT

maddie.meyersieck@transwestern.com
404.842.6509
License Number: #01961652